

# Annual Report

2015-2016

**Bold Changes on the Horizon**



*Transforming lives.*

**PRINCE GEORGE'S**  
COMMUNITY COLLEGE

# President's Message

This year at Prince George's Community College (PGCC) was the culmination of accomplishments achieved by the hard work and diligence of our students, faculty, and staff. We had much to celebrate, from a reassessment of college goals to college-wide technological and infrastructure upgrades, and recognition of excellence by regional and national education industry leaders.

Our faculty and students continued to excel in their respective fields and disciplines, reflecting not only the college's dedication to innovation, but also the work to improve the region. PGCC remained an active and important part of the greater community with new initiatives, such as the continued development of innovative Information Technology (IT) education and career pathways for Information Technology Early College (ITEC) high school students, and the development of our relationship with MGM National Harbor to support job training for county residents.

The dual enrollment program continued to be a priority for the college, nearly doubling in size from one semester to the next. New initiatives were implemented to increase participation and reduce barriers. A "hub school" was opened at Oxon Hill High School that serves both Prince George's County Public Schools' (PGCPS) dual enrollees and other current or potential students from the southern part of the county. Additionally, a 50% tuition assistance grant was created for all dual enrollees who continue to attend PGCC once they have graduated from high school.

The college continued its goal to increase diversity by creating a welcoming and inclusive environment that accepts and values uniqueness within the college community. PGCC was honored as an institution committed to diversity for 2015 during the Sixteenth National Role Models Conference sponsored by Minority Access, Inc., in Baltimore, Maryland.

The college's Capital Projects Campaign Planning Committee launched "It's Happening Here" to communicate the expansion of the college's capacity to achieve leadership in arts and culture; promote a welcoming environment; advance student-centered support; strengthen workforce development for emerging industries in the region; and build pathways to academic and career success.

With the help of education consultants edBridge Partners, LLC, and the continued support of the Board of Trustees, the college embarked on an institutional plan to align the resources (both human and financial), capabilities, and structure to best serve our students, prepare for the future, sustain the college, and achieve the vision and mission for the community we serve.

As always, the ultimate goal of all of our efforts is to serve a diverse student population by supporting their desire to transform their lives and using our abilities to assist in that transformation. As we look forward to the future, the entire college community has a tremendous opportunity to actively contribute to the student experience and success at PGCC.



Charlene M. Dukes  
President



# Envision Success

**Envision Success**, the FY14-FY17 strategic plan, represents the collaborative efforts of the entire college community to enhance student success and institutional effectiveness. During fiscal year 2016, PGCC implemented a variety of initiatives that addressed the goals and objectives of the strategic plan, reflecting the results of considerable dialogue, cooperation, and collegiality.

The Center for Faculty Innovation (CFI) held its kickoff on College Enrichment Day in October with both an opening announcement and several well-attended sessions. A multi-disciplinary committee reviewed and funded several innovative faculty applications in late fall 2015 and spring 2016. Some of the innovations included using SoftChalk and NearPod to provide learning in a more interactive way for students.



Over the summer, the faculty at PGCC and instructional specialists at PGCPS began to develop transition courses in English Language Arts, literacy, and Mathematics to assist high school students in acquiring the necessary skills to be college and career ready. This partnership addresses one of the parameters of Maryland's College and Career Readiness and College Completion Act of 2013.

In an effort to assist more eligible students to become dual enrollees, PGCC and PGCPS partnered to open a hub school in the southern part of the county. A ribbon cutting at Oxon Hill High School was held in June. In the fall, the first courses were offered to dual enrollees and open to other PGCC students.



The college accepted 22 new students in the first cohort of the Information Technology Early College (ITEC) Program at Chesapeake Math and IT Academy (CMIT) South. CMIT South is a newly established public charter high school in Upper Marlboro. The start of ITEC South was supported by a \$50,000 grant from Bank of America.

Through generous funding from the Gates Foundation, the Pathways Project, led by the American Association of Community Colleges and its seven partner organizations, was created to assist community colleges in designing and implementing academic and career guided pathways to serve all students. PGCC was selected as one of 30 community colleges from around the country to participate in the groundbreaking work. This year, the college sent Pathways teams to the first two of six Institutes and began to develop the supportive infrastructure to ensure the complete implementation of Pathways by fall of 2018.



### Associate Growth

Year	n	%
2012 Degrees	904	13%
2013 Degrees	963	7%
2014 Degrees	948	-2%
2015 Degrees	908	-4%
2016 Degrees	921	1%

### Certificate Growth

Year	n	%
2012 Certificates	370	9%
2013 Certificates	443	20%
2014 Certificates	399	-10%
2015 Certificates	212	-47%
2016 Certificates	206	-3%

### Credit and Noncredit Enrollment (Annual Unduplicated)

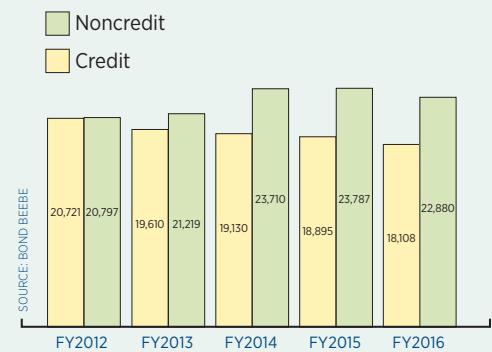

### Percent of Credit Students Receiving Financial Aid

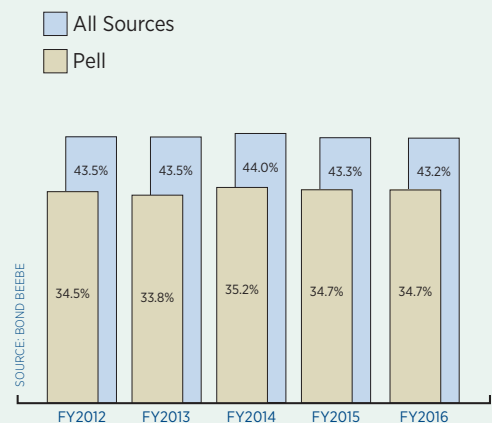

# Student Experiences

The staff and administrators within the area of Student Services continue to promote an environment that encourages students to complete their educational goals, prepares them for learning, and heightens their development and engagement inside and outside of the classroom. Here are some of the year's biggest success stories.

PGCC premiered its breakthrough documentary *Striving for the Extraordinary* based on the college's highly successful Diverse Student Male Initiatives (DMSI) program that was launched in 2009. The film chronicles the experiences of diverse male students as they embark on their academic journeys, learn profound life-changing lessons about themselves, and explore ideas to develop skills for personal success.

A new **Tuition Assistance Grant** (TAG) for Special Populations to assist in the recruitment and retention of students was developed. The proposed grant would offer students who participated in dual enrollment programs 50% tuition assistance on the current in-county rate, target those with a balance of \$500 or less, and encourage re-entry with a goal of degree completion.

The Adult Education program realized another year of increased enrollment to over 4,300 students.

PGCC launched the **Student Employment Readiness Program** (SERP), the first initiative of the college's Business Leadership Council (BLC) originated by the Prince George's Community College Foundation, Inc. The program was established with a special focus on developing participants' "soft skills." Fourteen students successfully completed the program in its first year, and received a \$1,000 stipend, thanks to the generosity of the BLC.



## Athletics

The Athletic Department continued to provide quality programs and experiences to the student athlete to enhance and support academic development and personal growth. The college strives to provide opportunities to student-athletes both on and off the field, supporting winning attitudes, sportsmanship, leadership, and success. The department's student athlete transfer rate was 77.7% for FY16 and many of those athletes continued their academic pursuits at such institutions as North Carolina A&T University, Pittsburgh University, Salisbury State University, and St. Mary's College of Maryland.

The college saw an impressive turnout for its first **Science, Technology, Engineering, and Math (STEM) Week**, with more than 50 students attending each event. The event was designed to increase students' interest in STEM fields and to provide them with soft skills. All events were free and open to all students, staff, faculty, and guests, and featured workshops and hands-on activities.

PGCC joined the **NSA Day Of Cyber**, a national initiative designed to raise the National IQ for STEM and cyber science careers. The initiative inspired the next generation of students through a self-guided interactive, online cybersecurity awareness experience called LifeJourney that enabled students to test-drive their future by living a day in the life of six NSA Cyber leaders.



**Men's Basketball** won the NJCAA Region XX Championship for the third year in a row.

**Monyea Early** was named the U.S. Track & Field and Cross Country Coaches Association (USTFCCCA) Women's Field Athlete of the Year. Ms. Early claimed national titles at the NJCAA DIII Championships in the heptathlon and triple jump, and finished in the top-three in the high jump and the long jump.

Many of PGCC's track and field athletes brought home honors this year, including **Joel Thomas** winning the men's 100m and 200m championships and **Krystal Simpson** winning the women's 200m championship. **Monyea Early** and **Coneisha Smith** captured 1st and 3rd in the 100m hurdles, respectively; they also claimed 1st and 2nd place in the high jump.

The **Men's Soccer** team was celebrated for their excellence off the field thanks to the group's overall GPA of 3.17 for the year. The team was nominated for the National Junior College Athletic Association (NJCAA) academic team of the year.



The **Women's Track** team was the NJCAA National Runner-up, representing the highest team accomplishment of any intercollegiate athletic team in the college's history.

# Class of 2016

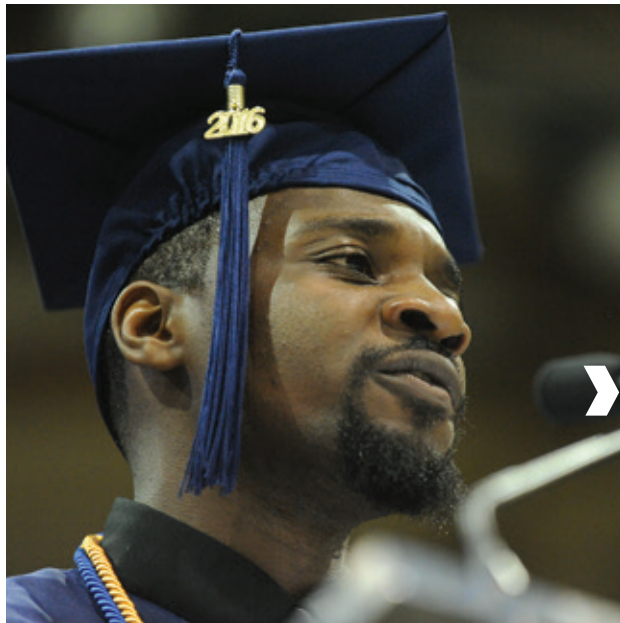

Prince George's Community College's 57th Commencement Exercises were held in May to celebrate the accomplishments of more than 1,100 hard-working graduates. Family, friends, faculty, and administrators gathered for the special ceremony to honor the students' achievements. The second graduating class of the Academy of Health Sciences received their high school diplomas in the morning, and their Associate of Arts degrees that evening.

Electrical engineering student **Adam Alston** served as student speaker during the 2016 Commencement Exercises. Alston transferred to the University of Maryland, College Park in the fall at the James Clark School of Engineering. Alston was the president of the college's National Society of Black Engineers chapter for two years. He was honored by NASA as an National Community College Aerospace Scholar (NCAS), and became an International Scholars Laureate of Engineering and Technology Nominee (which entails the opportunity to study abroad in China or New Zealand), and was a member of the Phi Theta Kappa Honor Society.



Prince George's County State's Attorney **Angela Alsobrooks** delivered the keynote address. In her current role as the county's top prosecutor, Alsobrooks heads a staff of 90 attorneys and 100 professional administrative staff responsible for prosecuting people accused of committing crimes. Her office has been a major factor in the record crime reduction seen in Prince George's County over the last four years. Additionally, she has taken the lead in reducing domestic and family violence in the county, by hosting conferences for couples and families in crisis.

**Natalia Mitiuriev** lived most of her life in Russia, where she and her siblings endured taunting from students and teachers alike because of their mother's American heritage, as well as some periods of homelessness. When Natalia was a teenager, her family moved to America in search of a better life, but her mother passed away from pancreatic cancer just two years later. Natalia knew that her mother would have wanted



her to finish her schooling, so she enrolled at PGCC. As an honor student and aspiring artist, she excelled in both digital and traditional art mediums and graduated with a 3.9 GPA. She now attends the University of Maryland, Baltimore County where she will complete her degree in 3D animation.

**Zarina Mohammad** moved to the United States from France 20 years ago. Even enduring a difficult and abusive marriage for 19 years could not stop Zarina's pursuit of higher education. When her husband would not allow her to leave the house to take classes, she enrolled in an online course at PGCC and received her first A, and that's when she knew she could do anything. Zarina, now the proud mother of four, received her associate degree in accounting and is continuing her studies at the University of Maryland University College. Zarina hopes to one day own her own accounting firm and set up low-interest loans and scholarships for financially challenged students.

**Eliane Lakam**, originally from Central Africa, received three associate degrees and two certificates from PGCC during this year's Commencement, graduating with a 4.00 GPA after spending every semester of her time here on the Dean's List. She earned a number of prestigious recognitions, scholarships, and awards, most recently the Tyrone F. Green Memorial Outstanding Student Leader of the Year Award and the Newman Civic Fellowship Award. Eliane transferred to Georgetown University to pursue interests in justice and peace, human rights, and politics. Eliane also was the student trustee on the college's Board of Trustees.



# Focus on Faculty and Staff

The college's national recognition for its innovative work is reflected through the success of its faculty and staff being awarded for their impact, helping to shape the field of higher education, and speaking at internationally attended conferences. Some examples include:



At the 96th Annual American Association of Community Colleges (AACCC) convention, the **National Council of Black American Affairs (NCBAA)** honored PGCC's Interim Vice President of Technology Services **Dr. Rhonda Spells Fentry** with the award for leadership.

Dean of Student Development Services **Dr. Scheherazade Forman** was elected to the Board of Directors of the **National Council on Student Development**.



**Dwayne Bourgeois**, Manager of Veterans Services, was elected **Vice Commander for the National Black Veterans Association (NABVETS)** chapter that serves Prince George's County.

**Dr. Nathaniel Calloway**, a professor in the Business Studies Department at PGCC and an adjunct associate professor at the University of Maryland University College, was elected **First Vice Commander of the American Legion Post 136**. Dr. Calloway has been a member of the organization for 28 years, and works with the PGCC Veterans Office outreach efforts for the American Legion.



**Dr. Diane Finley**, a professor in the Department of Psychology, won the American Psychological Association's 2015 **Excellence in the Scholarship of Teaching and Learning** at a Two-year College or Campus Award.

Interim Dean of Planning and Institutional Research **Dr. W. Allen Richman** presented at the Middle States Annual Conference in Washington, DC; at the Tk20 Annual Conference in Austin, TX; and Ellucian Live in Denver, CO.



**Casey W. O'Brien**, the Executive Director of the National CyberWatch Center, was honored by the Colloquium for Information Systems Security Education (CISSE) with the **2015 Academic Leadership of the Year** award.

## College Professional Development and Enrichment Day

College Professional Development and Enrichment Day is an annual event that brings college employees together to share experiences, exchange ideas, and participate in informative sessions. One of the highlights of the day is the Faculty and Staff Convocation, which is held to recognize the contributions employees have made to the college and community. The following staff and faculty were honored in October 2015.

**Dr. Margaret Jenkins**, an associate professor of Developmental English and Reading, was elected Secretary of the **Developmental Education Association of Maryland (DEAM)** for the 2016–2017 term.

The American Association of Women in Community Colleges (AAWCC) named PGCC President **Dr. Charlene Dukes** the Mildred Bulpitt **Woman of the Year** in recognition of her outstanding leadership and mentorship to women in community colleges. Dr. Dukes also briefed Capitol Hill members and staff on the Higher Education Act and Carl D. Perkins Career and Technical Education Act reauthorizations.

Ten PGCC administrators and staff were recognized with **National Institute for Staff and Organizational Development (NISOD)** Excellence Awards, recognizing individuals who are doing extraordinary work on their campuses and demonstrate excellence in teaching, learning and leadership at community and technical colleges.

\$25,000 of **FY2017 Impact Grants**, funded by the Prince George's Community College Foundation, Inc., were awarded to PGCC faculty and staff to implement new initiatives that support the strategic goals of the college. This year's funding went to:

- PGCC SportsNest Video (\$7,500.00)  
Project Director: Marshall Johnson
- PGCC Community in Unity and Homecoming Events (\$2,500.00)  
Project Directors: Paulett McIntosh and Stephanie Pair
- Recognition, Reflection, and Renewal: Strengthening the Adjunct Faculty Community (\$5,000.00)  
Project Director: Dennis Huffman
- Live Cablecast and Streaming from Remote Venues (\$9,972.55)  
Project Director: Gary Eldridge

The college bestowed **Faculty and Staff Service Awards** to honorees for their contributions and dedicated years of service to the success of PGCC and its students. Employees were celebrated for being a part of the PGCC community from five consecutive years to 30, 35, and 40 years!

### 2015

#### President's Medal Recipient

Dr. Christine Barrow

#### Full-time Faculty Honoree

Ms. Michelle Klein

#### Adjunct Faculty Honoree

Mr. Kuburat Bello

#### Workforce Development and Continuing Education

#### Adjunct Faculty Honoree

Mr. Dean Hodgson

#### Administrative and Professional Staff Organization Honoree

Dr. Allen W. Richman

#### Technical and Support Staff Organization Honorees

Ms. Kalika White

Mr. Lane Floyd

#### Most Community Service Hours and Most Hours of Service in Prince George's County Honoree

Ms. Carolyn Miller

*Financial Aid Support Specialist*

#### Most Community Service Locations Honorees (Tied)

Ms. Barbara McCreary

*WDCE Program Coordinator*

Mr. Frederick Sanford

*Adjunct Professor, Educational Development and Degree Centers*

#### Outstanding Service to the Share Food Network Project Honoree

Ms. Sadie Clark

*Executive Associate, Academic Affairs*



# Advancing Economic and Workforce Development



The **Prince George's Community College Dealer School** began classes in the spring. This new workforce training program provided students with the skills to apply for the 1,000 jobs that will be needed when the MGM National Harbor opens later in 2016. Hosted by PGCC's Office of Hospitality, Tourism and Culinary Arts Institute, the dealer school offered candidates the opportunity to learn traditional games including Blackjack, Roulette, Craps and Baccarat, and work with industry professionals.

Eighteen healthcare employers attended and shared job opportunities with participants during the 2nd annual **Certified Nursing Assistant Job Fair** for health care students. Thirty-percent of attendees received job offers.





PGCC developed a **new contract partnership** between the Children’s Developmental Clinic and Prince George’s County Public Schools Infants and Toddlers Program to provide services for 100 children with special needs. The clinic trained 259 PGCC and University of Maryland students to work with exceptional children in the areas of gross and fine motor skills; expressive and receptive language; and reading and social skills. The partnership provided education, resources and support to 150 parents of children with disabilities; and provided services for 240 children with special needs.

The **Westphalia Training Center** successfully launched and completed its first year of Welding Fundamentals. This course covers the most commonly utilized welding techniques, and all welds meet the American Welding Society (AWS) qualification standards.



With support from the Science, Technology, Engineering and Math (STEM) department, the college developed its first **Simulation and Game Development course**. This course’s launch represents the first step in a joint effort to offer a certificate program in this burgeoning industry, followed by degree pathways.

The college formed a partnership with Washington Metropolitan Area Transit Authority, Casa De Maryland and Prince George’s County Economic Development to provide Metro with **newly licensed bus drivers**.

The **TeamBuilders Academy** (TBA) was featured in Clark Construction’s spring 2016 Superstructure Magazine. The article, titled “First Class Completes Concrete Formwork Training at PGCC,” highlights the working relationship between Clark Construction’s self-perform group and the TeamBuilders Academy. The concrete curriculum is a nine-day boot camp that introduces students to construction math and blueprint reading, and experiential lessons in structural slabs, stairs, embeds, rebar, stripping, and finishing.



# College and Community

The Office of Recruitment hosted the **National Hispanic College Fair** on the college's main campus. Thirteen colleges were represented at the fair and over 500 high school students from the county attended. The college partnered with the Latino Student Fund (LSF) whose goal is to provide services to meet the educational needs of the Latino community in the Washington D.C. region.

**Maryland Governor Larry Hogan** toured the Academy of Health Sciences Middle College High School on June 15, 2016. Many elected officials have also visited the Academy this year, including then Maryland Congressman Chris Van Hollen, and members of the Maryland Education, Health and Environmental (EHE) Affairs Committee along with staff from the Department of Legislative Services (DLS).

For the fourth year, the college participated in the **President's Interfaith and Community Service Campus Challenge** designed to cultivate an appreciative knowledge and understanding of the diversity of our community. This year, committee members unveiled and dedicated a **Peace Pole** on the Largo campus to symbolize the oneness of humanity and our common wish for a world at peace. The Peace Pole bears the message "May Peace Prevail on Earth" in English, Spanish, French, and Arabic—the predominant languages of the PGCC community—on its four sides.



*“May Peace Prevail on Earth”*

—Peace Pole message



The **Financial Empowerment Center (FEC)**, located in the Center for Advanced Technology, officially opened to provide services to help individuals and families in Prince George’s County advance on a path toward financial stability. Services at the FEC include financial coaching, small business coaching, financial workshops and tax preparation, including prior year and amended tax returns.

Prince George’s Community College joined the **Heads Up, America!** campaign in support of universal community college for responsible students. Heads Up, America! builds awareness of the importance of obtaining higher education in order to be successful in the 21st-century job market and the realization of College Promise programs throughout the nation. Some of the College Promise campaign goals include making two years of college as debt-free and universal as high school, cutting the cost of college for all Americans, and improving the two- to four-year institution transfer processes and outcomes.

Brothers For A Cause, a nonprofit charitable organization that provides financial assistance and supportive resources to improve the lives and work skills of the economically disadvantaged, sponsored the **Third Annual 5K Run-Walk** in support of PGCC Cares. PGCC Cares is a college and community-wide effort to respond to the critical needs of students to help them to realize their academic goals including graduation, transfer, and entry into the workforce.

# Facility & Technology Enhancements



PGCC strives to continually enhance the quality of college life by delivering optimal services to support the evolving needs of our entire community.

The college launched the construction phases for the new **Culinary Arts Center, Lanham Hall Renovation and Addition**, and the **Queen Anne Renovation and Addition**.

- The new 21,000 square-foot Culinary Arts Center will provide enhanced opportunities for the college's culinary arts and hospitality fields. The building will also house laboratories where culinary and hospitality students can put the skills they learn in class into practice. Some of these skills include food preparation, food service management, and meeting and event planning.
- The updated, 92,000 square-foot Lanham Hall will provide a central location for the college's Workforce Development and Continuing Education (WDCE) programs as well as academic affairs and student support programs and services.
- The existing Queen Anne Fine Arts Building will be expanded and transformed into a new, state-of-the-art facility serving the college's Liberal Arts departments and various Workforce Development, Student Services, and community outreach programs.



Culinary Arts Center—Opens Spring 2018

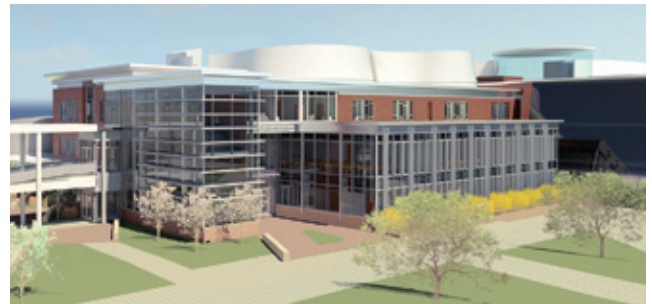

Lanham Hall—Opens Fall 2018



Queen Anne—Opens 2019

Technology infrastructure, network switches, AV technologies, and security systems were installed in the **new headquarters of Campus Police and the Facilities Management Department**. The new Emergency Command Center, roll-call room, conference room, and offices have improved access to technology resources that allow centralized monitoring of college-wide emergency communications systems.



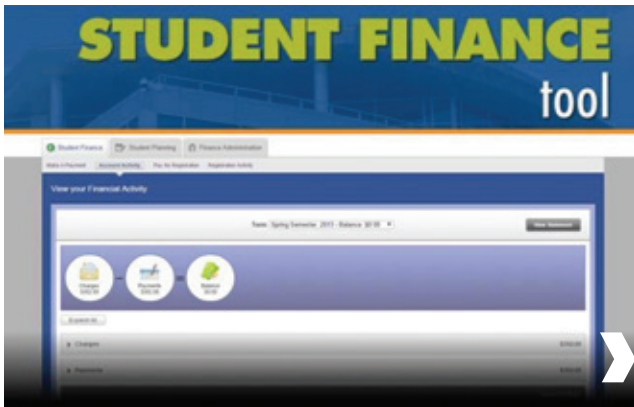

A new **Financial Aid Self-Service module** was implemented, providing students with an intuitive, Web-based interface for completing the Financial Aid process. Students are now able to submit an application, accept their award package, and electronically sign their financial aid award letter through a single Web interface. The system provides students with real-time Financial Aid alerts and notifications that allow timely completion of Financial Aid documents.



Prince George's Community College Foundation, Inc.'s scholarship system has been replaced with **AcademicWorks**, a more efficient and user-friendly system that streamlines the scholarship application and award process, allowing the Foundation to more efficiently match students' needs with scholarship dollars.

The college deployed **51 student mobile charging stations** on the Largo Campus, Laurel College Center, University Town Center, Westphalia Training Center, and Joint Base Andrews. The stations include their own charging cords and can support a variety of smartphones and tablets.



The launch of the Acalog **cloud-based online course catalog** provides students and faculty with dynamic, interactive access to catalog information that is up to date, accurate, and timely.

Cloud-based **Enrollment Management Recruiter Software as a Service** (SaaS) was implemented to support and personalize all stages of the recruitment and admissions lifecycle for prospective students. The system streamlines operations while making it possible for the college to find the best prospects in an efficient and effective manner.

By **enhancing PGCC-TV broadcast capabilities** through live streaming, viewers can access broadcast content via the college website and the cable channels (Verizon FIOS channel 44 and Comcast channel 75/995). With the activation of Video on Demand for PGCC-TV programming, college website visitors have 24/7 access to archived content.

# Alumni Achievements



Alumni from the first graduating class of the **Academy of Health Sciences @ PGCC** participated in an **Alumni Chat** with current middle college students to provide a unique opportunity for the alumni to share their experiences at the college, and more recently, at their respective universities—some of the most challenging and prestigious colleges in the state and country.

A number of new scholarships were established in FY2016, including the **Friendly High School Alumni Scholarship**, which helps send graduating high school seniors from their alma mater to PGCC. Another new initiative is the **Armed Forces Communications and Electronics Association (AFCEA) STEM Scholarship**; this endowed scholarship was started with a \$50,000 gift from the AFCEA Central Maryland Chapter to support students in STEM majors at PGCC.

On the heels of the Purpose, People, Possibilities campaign, which was the largest concerted fundraising effort in the history of the college, the Office of Institutional Advancement and the PGCC Foundation spent FY15–16 facilitating infrastructure enhancements and helping the college fulfill its highest strategic priorities of retention and completion.



# Prince George's Community College Foundation, Inc.

*Purpose, People,  
Possibilities*

The Capital Projects Campaign Planning Committee, led by the Office of Institutional Advancement, planned and executed “**Groundbreaking Day at Prince George’s Community College.**” This event is the first of many over two years to engage and update stakeholders on the college’s three major capital projects: Lanham Hall renovation and addition; Queen Anne renovation and addition; and a brand new Culinary Arts Center. The event’s theme “**It’s Happening Here**” communicates the college’s goals to expand its capacity to achieve leadership in arts and culture; promote a welcoming environment; advance student-centered support; strengthen workforce development for emerging industries in the county; and build pathways to academic and career success.



**Mr. Logan Gaskill**, the vice president of Human Resources at MGM—National Harbor, was appointed to the Prince George’s Community College Foundation, Inc. Board of Directors. Mr. Gaskill expressed a desire to work closely with the college on initiatives that will positively impact workforce development in the county. MGM is a strategic partner of the college and has made a \$150,000 gift to the Foundation for scholarships and program support for students in hospitality and culinary arts programs.

# Building Resources: Grants

The **U.S. Department of Education** awarded a five-year, \$1,778,400 grant to the college for continuation of its TRIO Student Support Services Program. This program serves 275 eligible PGCC students by providing services and activities designed to increase students' retention, graduation, and transfer rates. Services include student success workshops, mentoring initiatives, academic and financial aid advising and coaching, tutoring, educational and cultural activities, and more.



The **Bank of America Foundation** contributed \$50,000 to the college to support continued development of innovative Information Technology (IT) education and career pathways for Information Technology Early College (ITEC) high school students. ITEC addresses the need to increase opportunities for high school students to earn up to 60 college credits and at least one industry certification through dual enrollment,

and provides academic and career counseling, and professional development supported by technology-enhanced learning spaces and mobile technology. The Bank of America funding increases ITEC's capacity to support a pipeline of qualified underrepresented students and enhance their potential to earn family-sustainable wages in STEM career pathways.





The **United Way of the National Capital Area** awarded a grant of \$30,000 to support the continued operation of the PGCC Veterans Center to improve student engagement and a sense of belonging among the extended veteran population at PGCC. These funds enable the center to offer specialized veteran workshops facilitated by outside experts, enhance the services the Veterans Center offers in partnership with the PGCC Financial Empowerment Center, provide training to staff in the Office of Veterans Services, implement outreach activities designed to promote the Center's services, and provide other academic, personal, and social programming.

A grant of \$20,000 from the **Maryland State Department of Education** funded enhancements to the nursing program's simulation labs, including neonatal and pediatric simulation equipment upgrades and additions. This simulation equipment provides students with the realistic experience needed to learn and practice the skills required for certification/licensure exams.



# Fiscal Year 2015–2016 Grants

## Federal

Name of Grant	Project Director	Amount	Funding Source
TRIO: Student Support Services	D. Norwood	\$1,778,400	U.S. Department of Education
<b>Federal Total:</b>		<b>\$1,778,400</b>	

## State/Local

Name of Grant	Project Director	Amount	Funding Source
Health Personnel Shortage Incentive	A. Anderson	\$6,000	Maryland Higher Education Commission
English as a Second Language Training for Legal Refugees in Prince George's County	S. Greenback	140,290	Maryland Office for Refugees and Asylees
Child Care Career & Professional Development Fund	A. Williams	78,878	Maryland State Department of Education
FY2016 Local Career & Technical Education (CTE) Plan for Program Improvement	C. Lapalombara A. Washington	645,060	Maryland State Department of Education
FY2016 Career & Technical Education (CTE) Reserve: Neonatal and Pediatric Simulation Upgrade	A. Anderson	20,000	Maryland State Department of Education
FY2016 Consolidated Adult Education & Literacy Services Program	J. Walpole	1,859,660	State of Maryland Department of Labor, Licensing, and Regulation (DLLR)
Children's Developmental Clinic	S. Gagnon	62,239	Prince George's County Government
NEXT STEP	C. Knox	275,000	Prince George's County Department of Social Services
Annual Bluebird Blues Festival	M. Nicholson	2,728	Maryland State Arts Council
<b>State/Local Total:</b>		<b>\$3,089,855</b>	

# Fiscal Year 2015–2016 Grants

## Corporate/Foundation (Non-Governmental)

Name of Grant	Project Director	Amount	Funding Source
Veterans Center Operations at Prince George's Community College	D. Bourgeois	\$30,000	United Way of the National Capital Area
Mid-Atlantic Teaching of Psychology (MATOP) Conference Support	D. Finley	1,000	American Psychology Association
Prince George's Saves	B. Habershon	2,000	Consumer Federation of America
Information Technology Early College	M. Doss	50,000	Bank of America
Women's Academic Success Advisory Committee Stepping Stones Initiative	C. Knox	40,000	Washington Area Women's Foundation
Prince George's Community College Local Economic Development	D. Buonara	49,935	Capital One Foundation
Surgical Technology Simulation Expansion	A. Anderson	50,000	Kaiser Permanente
Entrepreneurship Development Program	R. Lewis	15,000	Capital One Foundation
Financial Empowerment Center at Prince George's Community College	B. Habershon	105,000	United Way of the National Capital Area
Higher Learning Support Funds—unrestricted	B. Mitchell	50,000	Philip L. Graham Fund
2016 VITA Grant	B. Habershon	3,750	Maryland CASH Campaign

**Corporate/Foundation (Non-Governmental) Total: \$396,685**

**Grand Total—Fiscal Year 2016: \$5,264,940**

# Donors FY2016

## Legacy Circle \$100,000 and up

Hillman Family Foundation  
Kathy & Jerry Wood Foundation, Inc.  
MGM Resorts—National Harbor  
Southern Management Corporation  
United Way of the National Capital Area

## Visionary Circle \$50,000–\$99,999

AFCEA of Central Maryland, Inc.  
Bank of America Foundation  
Capital One Financial Corporation  
Kaiser Permanente  
Philip L. Graham Fund

## President's Circle \$10,000–\$49,999

Antiok Holdings Inc.  
Citi  
Audrey C. Davis\*  
Derick Associates, Inc.  
Estate of Betty Pecolia Spence  
Lockheed Martin  
Pepco Holdings, Inc.  
Walton Development & Management  
Washington Area Women's Foundation

## Deans Circle \$5,000–\$9,999

AOBA Alliance, Inc.  
Clark Construction Group, LLC  
Dr. Charlene M. Dukes  
Follett Higher Education Group  
G.S. Proctor & Associates, Inc.  
Mr. and Mrs. Haden A. and Cathy Land  
Maryland State Arts Council  
Prince George's Chamber of Commerce  
Prince George's Community College  
Board of Trustees  
Tarrant County College District  
The Hershey Company

## Partners \$2,500–\$4,999

CSO Research, Inc.  
Ford Management Services, Ltd  
HR in Motion, LLC  
Thomas E. Knapp  
Lanier Electronics Group, Inc.  
Lendana Construction Company, LLC  
Prince George's County Executive  
Rich Moe Enterprises, LLC  
Dr. Joseph G. Rossmeier  
Sandy Spring Bank  
Scott Management, Inc.  
Alonia C. Sharps  
Silver Hill Lions Club  
Six Flags America  
Soft-Con Enterprises, Inc.  
Stanley Security Solutions, Inc.  
Woodmore Restaurant Holdings, LLC

## Patrons \$500–\$2,499

Timothy J. Adams  
Rosie Allen-Herring  
Angela D. Anderson  
Montez Anderson  
William L. Anderson  
ASAPGC, Inc.  
Arthur Asuncion  
Baltimore/Washington Chamber  
of Commerce  
Oretha Bridgwaters-Simms  
Brinktank LLC  
Nancy E. Burgess  
Central Wholesalers, Inc.  
Consumer Federation of America  
Daycon Products Company, Inc.  
Delta Alumnae Foundation Inc.  
of Prince George's County  
Dr. Sandra F. Dunnington  
Electric Entertainment  
Sidney L. Gibson  
Robert B. Hammond  
Dr. Carlise J. Harris  
The JBG Companies  
Eliane Lakam  
Rene B. LaVigne  
Maryland Health Information  
Management Association  
Dr. Kevin M. Maxwell  
MdBio Foundation Inc.  
Dr. P.J. Mehta  
Brenda S. Mitchell  
Lori F. Morris



Sabrina Nash  
National Institute of Standards  
& Technology  
Northern Virginia Community College  
Samuel Parker, Jr.  
The Pew Charitable Trusts  
PGCC Better Together Student Club  
PGCDA Foundation, Inc.  
Prince George's Conference  
& Visitors Bureau  
Prince George's County Public  
School System  
R.D. Jones & Associates, Inc.  
Danit P. Rainey  
Norma Raey  
Joseph D. Redmiles  
Arlene I. Robinson  
Sharon Saylor  
Arvie Z. Scates  
Skyline Technology Solutions  
Stanton Glenn/Vista Ridge LP  
Dr. Lynette J. Steele  
Howard W. Stone, Jr.  
Stephen Sturiale  
System Applications & Technologies, Inc.  
The University of Maryland  
Foundation, Inc.  
Valcourt Building Services, Inc.  
Verizon Foundation  
William C. Smith & Company  
Women of Excellence NWAS, Inc.  
Dr. Janice L. Wright  
Jennifer Yohe Wagner  
Zonta Club of Prince George's County

## Friends \$1-\$499

Accounting Unlimited, Inc.  
Dr. I. Lynne Ada  
Muriel H. Ada  
Mr. and Mrs. Sidney U. Allen  
Anne Arundel Community College  
Dr. Laura Ariovich  
Arkansas State University Beebe  
Mark Luis Arrieta  
Manuel Arrington  
Arthritis Foundation  
Nilaya Baccus-Hairston  
Suzanne L. Baczynski  
Deborrah M. Banks  
Donna M. Barker  
Kenneth Reginald Barnes  
Christine E. Barrow  
Gay Van Beek  
Calvin Bell  
Kevin D. Bellamy  
Thomas A. Berault  
Dr. Susan Biro  
William F. Blank  
Bloomberg University  
Michael Blumenstock  
Katrina Boverman  
Bowie Senior Center  
Bowie State University  
Jacqueline A. Bowman  
Cheryl Brickus  
Kevin J. Bright  
Ellen D. Brown  
Gita A. Brown

Kristal A. Brown  
Tiffany L. Brown  
Laura L. Brown-Lucas  
Eleanor Bullock-Mitchell  
Reeda Butler  
Diane Connelly Butler  
Anitra E. Butler-Ngugi  
Mona Calhoun  
Gladys Cambrel-Crockett  
Cathryn L. Camp  
Capitol Technology University  
Rhoderick Gayland Carethers  
James Carlson  
Leslie H. Carr  
Brenda Carrington  
B.J. Carter  
Cherry Carter  
Catawba Valley Community College  
Carol A. Cavanaugh  
CBS Radio  
Cheryl V. Chambers  
Juliana H. Chang  
Michael Chikere  
Linda Daniels Chitta  
Stanley F. Choate  
Vincent P. Cipriani  
Lily G. Clark  
Helen A. Coe  
Alicia Denise Coffey  
Marlene C. Cohen  
Clifford L. Collins  
Community Pool Service, LLC  
Patricia A. Connolly  
County College of Morris

Naomi M. Cowgill  
Craven Community College  
Cassandra Creek  
Adrienne M. Crowell  
Dr. Patricia A. Cunniff  
Lindsey Curley  
William Daniels, Jr.  
Jennifer Dasilva  
Jeannette Davis  
Geri Priscilla Davis  
Joel A. Dearing  
Yosef N. Degife  
Beth Michelle Dempsey  
Brian D. DeNard  
Colonel Duane DeVance  
Janet L. Dinkins  
Tracy Dirks  
Lark T. Dobson  
Doctors Community Hospital, Inc.  
Mary Ann Donnelly  
Dr. Mara R. Doss  
Lynette Doyle  
Johnika Dreher  
Jeffrey A. Drexler, M.D.  
Cornell Dunlap  
Daryck C. Dupree  
East Carolina University  
Educational Data Systems, Inc.  
Christa Edwards  
Barbara Cartin Engh  
June L.W. Evans  
Opeoluwa Fagbemi  
Bettyanne Fale  
Mary C. Falkey  
Bonnie Fetsko  
Claudio C. Flage

Eileen C. Flage  
Elaine E. Foster  
Robbye Fox  
Sean Fraser  
William D. Frazier  
Dr. Melinda J. Frederick  
Frederick Community College  
Dr. William A. Fry  
Mount O. Fulcher  
Gerald Scott Furner  
William N. Gardner  
Diane L. Garrison  
Wendell J. Gaskins  
Donna Gaughan-Wilson  
Cheryl George  
George Mason University  
Jeanette Gerrity Gomez  
Solomon Gherezgher  
Nicklaus Giacobbe  
Sara R. Gilbert  
Karen L. Gill  
Deborah A. Gleaton  
Sandra L. Gorrell  
Cynthia M. Graham  
Randolph Graham  
Kathleen M. Gray  
Marcellus Grayson  
Jacqueline J. Grey  
Nancy L. Grinberg  
Goedele Gulikers  
Hagerstown Community College  
Allen J. Hall, Sr.  
Craig Hall  
Amanda Hamilton  
Veronica J. Hammonds  
Charles E. Hansborough

Dwight Harbin  
Harford Community College  
Caitlin Harris  
Doris M. Harris  
Ruth G. Harris  
Thomas R. Haslinger  
Cheri C. Hawkins  
Charles Hawkins, Sr.  
Richelle Hawkins  
Eunica Haynes  
Linda A. Head  
Bruce T. Heitke  
Karien Henderson  
Arthur Hibbert  
Michelle T. Higgs  
Donyel Hill  
Toni E. Hill  
Hillside Family of Agencies  
LaTonya Holland  
Deidra Hollingsworth  
Hood College  
Jasmine Hopewell  
Richard J. Hopewell, Jr.  
Manzoor Hossain  
Dr. Nadene R. Houser-Archield  
Howard Community College  
Bruce Hughes  
Brenda C. Hunter  
Debra Hutchins  
Ryan Nathan Hutchison  
Allen Ingling  
Nicole R. Ives  
Clifford Louis Jackson  
Elaine Jackson  
James Madison University  
Regina Jeffries

Dr. Margaret H. Jenkins	Literacy Council	Barbara J. Miller
Patricia E. Jenkins	of Prince George's County	Michael Miller
Jenkins Environmental, Inc.	Livingston Lease Company, LLC	Millersville University
Job Opportunities Task Force	Jeremy M. Long	David Milligan
Gail Johnson	Carlos E. Lopez	Brian Misterek
James M. Johnson	Thandiwe F. Lowe	Shellie Monroe
Leroy M. Johnson	Donita R. Lucas-Brown	Monroe Community College
Lorraine W. Johnson	James R. Lyles, Sr.	Plato Zuno Moore
Marshall Johnson, Jr.	Traci Lynch	Karen Marie Moorman
Andy D. Jones	Joan Macdonnell	Dr. David C. Mosby
Anthony Jones	Carrie Lael Mack	Delphine Motley
Dr. Daniel F. Jones	Macy's, Inc.	Mr. & Mrs. Jerry Murrell
Kenneth G. Jones, Jr.	Shirley Malone	National CineMedia*
Benita Jones-Davidson	Mansfield University of Pennsylvania	National Council of Negro Women, Inc.
Isha Kamara	Pamela Marcus	Dr. M. Salah Negm
Tomba Kambui	Lucy W. Marr	Waleed S. Negm
Dr. Leela Kapai	Anthony J. Marra	Elizabeth Nehrbass
Leora Kaye	Marshall University	Ann Harrison Nelson
Duke A. Kelly	Taunya Martin	Joyce Nelson
Nicola Kennedy	The Family of Joseph L. Martinelli	David Newman, Jr.
Barbara Jean King	Maryland Community Connection	David B. Nickerson
Michael J. Klein	Maryland Pizza Inc.	Mary K. Njah
Roxann M. King	Mary Merrill Mason	Norfolk State University
Cecelia A. Knox	Kier Maxwell-Hubert	North Carolina State University
Fatima K. Lamar-Taylor	Carrol H. McBryde	David P. Notley
Kathaleen Lane	Suzanne McCarthy	Frances Allen Notley
Mr. and Mrs. Curtis W. Langford	Carol McHale	William L. O'Hare
Catherine A. Lapalombara	Paulett McIntosh	Aimee E. Olivo
Johnny David Latimer, Sr.	Virginia McKenzie	Promise A. Olomo
Jeffrey Leadmon	Edward McLaughlin	OMG RE Leasing Co., LLC
I. Jean Lee	Marie McLean	Christopher Overby
Dr. Tyjaun A. Lee	Marcus Benjamin McMullen	Gbenga Owolabi
Anita Lewis	Gaston L. McNeill	Rufus H. Parker, III
Ruth V. Lewis	Joyce H. McPherson	Peter Patente
Liberty University	Byran McReynolds	Joan H. Patterson
Mary Lindsay	Teresa McTigue	Olaf Pedersen, III

George S. Perkins  
Joseph Winfield Pindell  
Cathrine A. Polcen  
Debora Pollock  
Yma Ponton  
Dorothy A. Posey  
PPE Casino Resorts Maryland, LLC  
Elizabeth G. Proctor  
Quantum Realty Management, Inc.  
Steven A. Queirolo  
Dixie Quinn  
Radford University  
Randolph Community College  
Cathy Ratte  
Dr. Beverly S. Reed  
Charles E. Reid  
Mr. & Mrs. Louis C. Renaud, Jr.  
Mr. & Mrs Michael & Kim Rhim  
Lee B. Richardson  
Mark Rickert  
Catherine Rigby  
Deborah Rigby  
Roy Riley  
Davetta Rinehart  
Ann B. Robinson  
Andristine M. Robinson  
Mr. & Mrs. Charles Robinson  
Jane Robinson  
Debra Lynn Rodriguez  
Kevin Ross  
Dr. Margaret A. Ross  
George Lawrence Rusnak  
Ruth Constance Russell  
Saint Vincent College  
William R. Scott  
Lawrence Sedgwick  
Mr. & Mrs. Septimus Aberdeen

Donnie Liggon Shaw, Jr.  
Mary Jane Shearer  
Lloyd Simmons  
Sylvia L. Simmons  
Gilda Simons  
Donna Simpkins-Watson  
Sinclair Community College  
Crystal M. Smith  
Karen T. Smith  
Robert Smith  
Sharon J. Smith  
Jeffrey L. Snodgrass  
Southwestern Illinois College  
Donald Sparks  
Dr. Rhonda Spells-Fentry  
Darline L. Spriggs  
Mr. and Mrs. H. Allen Stearns  
Aaron Steeves  
Laurie Gabrielle Stiles  
Christina Streets  
Susie Sturiale Quinn  
Milton S. Taylor, Sr.  
Phyllis Taylor  
Dr. Brenda D. Teal  
Brenda V. Thaxton  
The Arc Prince George's County  
The Urhobo Association  
of Washington DC  
Lauren Theodore  
Lt. Col. (ret.) Charles A. Thomas  
Percell Thomas  
Kevin N. Thompson  
Priscilla C. Thompson  
Elaine Todd  
Mirian Torain  
Dwayne Torney  
Towson University

Jane Treadwell  
Orlando Treadwell  
University of Maryland Baltimore County  
University of Maryland College Park  
University of Maryland University College  
Wanda M. Van Goor  
Rebecca G. Virta  
Denise A. Walker  
Sheila R. Walker  
Theresa S. Walker  
Sandra Walsh  
Anthony Demond Washington  
Dr. & Mrs. Leon D. Weaver  
Wegmans Food Markets, Inc.\*  
Leonora Weimer  
Tyrone Wells  
West Virginia University  
Jackie White  
Kalika Robin White  
Peter White  
Tom Wikoff  
G. Laverne Willia  
Gary L. Willia  
Laverne Willia-Lewis  
Pauline Willia  
Sherelle R. Williams  
Shanita Willia-Young  
Shannon Williams  
Wilmington University  
Shawn Jackson Wilson  
Pamela A. Wilson  
Rev. Clevester O. Wimbish  
Marcella Wright  
Mary D. Young



Artist's Rendering of the main stage  
in the new Queen Anne building,  
currently under construction

## Statement Of Net Position for the Year Ending June 30, 2016

<b>Assets</b>	<b>2015</b>	<b>2016</b>
<b>Current Assets</b>		
Cash and Cash Equivalents	\$32,213,380	\$17,275,863
Accounts Receivable—Net of Allowance	19,987,941	23,890,579
Grants Receivable	1,858,462	3,067,722
Inventories—At Average Cost	105,495	132,365
Prepaid Expenses	1,587,289	1,822,858
<b>Total Current Assets</b>	<b>\$55,752,567</b>	<b>\$46,189,387</b>
<b>Other Assets</b>		
Grants Receivable	\$643,564	\$0
Land	2,772,440	2,772,440
Buildings and Improvements—Net of Depreciation	127,294,515	141,204,402
Furniture and Equipment—Net of Depreciation	13,276,892	9,780,152
<b>Total Other Assets</b>	<b>\$143,987,411</b>	<b>\$153,756,994</b>
<b>Total Assets</b>	<b>\$199,739,978</b>	<b>\$199,946,381</b>
<b>Deferred Outflows</b>	<b>\$485,868</b>	<b>\$1,431,947</b>
<b>Liabilities</b>	<b>2015</b>	<b>2016</b>
<b>Current Liabilities</b>		
Accounts Payable and Accrued Liabilities	\$12,160,489	\$12,629,218
Compensated Absences	262,996	296,876
Capital Lease Obligations	1,816,403	875,145
Deferred Revenue	1,781,149	1,595,011
<b>Total Current Liabilities</b>	<b>\$16,021,037</b>	<b>\$15,396,250</b>
<b>Non-current Liabilities</b>		
Compensated Absences	\$2,266,791	\$2,070,462
Capital Lease Obligations	1,366,188	491,043
Net OPEB Obligation	1,396,019	1,327,287
Net Pension Liability	3,221,728	4,331,013
<b>Total Non-current Liabilities</b>	<b>\$8,250,726</b>	<b>\$8,219,805</b>
<b>Total Liabilities</b>	<b>\$24,271,763</b>	<b>\$23,616,055</b>
<b>Deferred Inflows</b>	<b>\$ 352,639</b>	<b>\$353,175</b>
<b>Net Position</b>	<b>2015</b>	<b>2016</b>
<b>Invested In Capital Assets—Net of Related Debt</b>	\$140,318,20	\$151,429,995
<b>Restricted For</b>		
Expendable Student Loans	181,465	181,464
Scholarships and Fellowships	46,025	104,359
Entrepreneurial and Technology Programs	2,577,198	2,352,237
<b>Unrestricted</b>	<b>32,478,548</b>	<b>23,341,043</b>
<b>Total Net Position</b>	<b>\$175,601,444</b>	<b>\$177,409,098</b>

## Statement of Revenues, Expenses and Changes in Net Assets for the Year Ending June 30, 2016

<b>Operating Revenues and Expenses</b>	<b>2015</b>	<b>2016</b>
Student Tuition and Fees—Net of Scholarship	\$26,678,618	\$27,205,092
Federal Grants and Contracts	6,054,068	5,237,387
Gifts and Grants	1,005,184	58,333
Auxiliary Enterprises	649,230	822,144
Agency Revenues	207,077	313,164
Other Revenues	456,776	157,573
<b>Total Operating Revenues</b>	<b>\$35,050,953</b>	<b>\$33,793,693</b>
<b>Operating Expenses</b>	<b>2015</b>	<b>2016</b>
Instruction	\$41,586,853	\$39,140,634
Research	30,460	42,497
Public Services	372,637	329,162
Academic Support	18,942,619	18,554,748
Student Services	10,432,769	11,402,098
Institutional Support	26,037,191	27,560,678
Plant Operations and Maintenance	10,402,575	10,995,180
Scholarships and Fellowships	6,535,522	4,762,026
State Paid Retirement Benefits	5,856,306	5,925,718
Depreciation Expense	9,181,209	10,187,231
<b>Total Operating Expenses</b>	<b>\$129,378,141</b>	<b>\$128,899,972</b>
<b>Operating Revenue (Loss)</b>	<b>\$(94,327,188)</b>	<b>\$(95,106,279)</b>
<b>Non-operating Revenues (Expenses)</b>	<b>2015</b>	<b>2016</b>
State of Maryland	\$25,210,654	\$26,072,536
County Appropriation	30,345,300	31,648,800
Federal Pell Grants	20,088,345	16,789,188
State Paid Retirement Benefits	5,856,306	5,925,718
Restricted Donations—Scholarships	626	1,632
Restricted Gifts and Grants	4,512,125	4,036,632
State of Maryland Programs	348,727	408,274
Interest Expense	(60,334)	(31,651)
Earnings from Invested Funds	18,321	46,117
County Programs	700,000	700,000
<b>Total Non-operating Revenues</b>	<b>\$87,020,070</b>	<b>\$85,597,246</b>
<b>Income (loss) Before Other Revenues, Expenses, Gains or Losses</b>	<b>2015</b>	<b>2016</b>
	\$(7,307,118)	\$(9,509,033)
Capital Appropriations	\$16,092,950	\$11,316,687
Net Position at Beginning of Year —As Previously Reported	169,944,531	
Cumulative Effect of Change in Accounting Principal	(3,128,919)	
<b>Net Assets</b>	<b>2015</b>	<b>2016</b>
Increase in Net Assets	\$5,656,913	\$1,807,654
Net Assets at Beginning of Year	\$166,815,612	\$175,601,444
Net Assets at End of Year	\$175,601,444	\$177,409,098

### **2016 Board of Trustees**

Aimee E. Olivo, Chair

Samuel J. Parker, Jr., Vice Chair

Oretha Bridgwaters-Simms

Sidney L. Gibson

Howard W. Stone, Jr.

C. Michael Walls, Esquire

Floyd E. Wilson, Jr.

Eliane Lakam, Student Trustee

### **President**

Dr. Charlene M. Dukes

Prince George's Community College

301 Largo Road

Largo, Maryland 20774-2199

301-546-PGCC (7422)

**[www.pgcc.edu](http://www.pgcc.edu)**



*Transforming lives.*

**PRINCE GEORGE'S**  
COMMUNITY COLLEGE